

UNIT "A-2-MODIFIED"

3 BEDROOMS, 4 1/2 BATH, FAMILY RM & STUDY

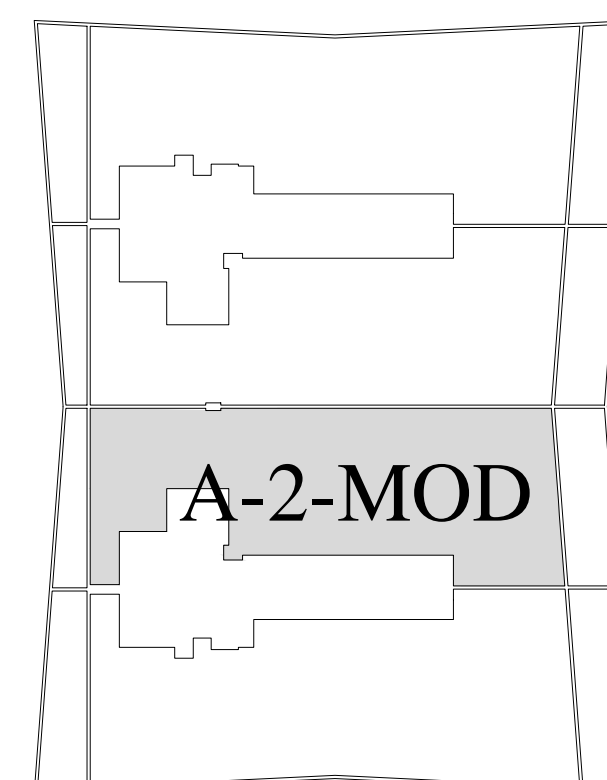
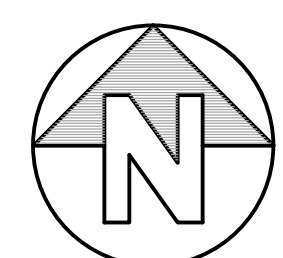

UNIT 'A-2-MODIFIED'

RESIDENCE AREA	= 2,900 SQ.FT. / 269.4 SQ. M.
BALCONY AREA	= 650 SQ.FT. / 60.4 SQ. M.
TOTAL RESIDENCE	= 3,550 SQ.FT. / 329.8 SQ. M.
PAINT-TO-PAINT AREA	= 2,616 SQ.FT. / 243.0 SQ. M.

NOTE: PLAN MATERIALS AND SPECIFICATIONS ARE SUBJECT TO ARCHITECTURAL AND OTHER REVISIONS AT THE SOLE DISCRETION OF THE DEVELOPER, BUILDER OR ARCHITECT, OR AS MAY BE REQUESTED BY LAW. FLOOR PLANS MAY NOT BE TO SCALE. ANY FURNITURE, APPLIANCES OR DECORATOR READY ITEMS DEPICTED HEREIN ARE SHOWN FOR ARTISTIC AND ILLUSTRATIVE PURPOSES ONLY AND ARE NOT INCLUDED IN THE PURCHASE AND SALE OF THE RESIDENCE.

STATED DIMENSIONS ARE MEASURED TO THE EXTERIOR BOUNDARIES OF THE EXTERIOR WALL AND THE CENTER LINE OF THE INTERIOR DIMENSIONING WALLS AND, IN FACT, VARY FROM THE DIMENSIONS THAT WOULD BE DETERMINED BY USING THE DESCRIPTION AND DEFINITION OF THE "UNIT" SET FORTH IN THE DECLARATION WHICH GENERALLY ONLY INCLUDES THE INTERIOR AIRSPACE BETWEEN THE PERIMETER WALLS AND EXCLUDES INTERIOR STRUCTURAL COMPONENTS. ADDITIONALLY, MEASUREMENTS OF ROOMS SET FORTH ON ANY FLOOR PLAN ARE GENERALLY TAKEN AT THE GREATEST POINTS OF EACH GIVEN ROOM AS IF THE ROOM WERE A PERFECT RECTANGLE, WITHOUT REGARD FOR ANY CUT OUTS. ACCORDINGLY, THE AREA OF THE ACTUAL ROOM WILL TYPICALLY BE SMALLER THAN THE PRODUCT OBTAINED BY MULTIPLYING THE STATED LENGTH TIMES THE WIDTH. ALL DIMENSIONS ARE APPROXIMATE AND ALL FLOOR PLANS AND DEVELOPMENT PLANS ARE SUBJECT TO CHANGE.

ORAL REPRESENTATIONS CANNOT BE RELIED UPON TO CORRECTLY STATE THE REPRESENTATIONS OF THE DEVELOPER. ALL REAL ESTATE SHOWN HEREIN IS SUBJECT TO THE US FEDERAL FAIR HOUSING ACT OF 1968. FOR CORRECT REPRESENTATIONS, MAKE REFERENCE TO THE DOCUMENTS REQUIRED BY SECTION 718.501 FLORIDA STATUTES, TO BE FURNISHED BY THE DEVELOPER TO A BUYER OR LESSEE. OBTAIN THE PROPERTY REPORT REQUIRED BY FEDERAL LAW AND READ IT BEFORE SIGNING ANYTHING. THIS IS NOT AN OFFER OR CONTRACT TO SELL, OR SOLICITATION OF OFFERS TO BUY THE CONDOMINIUM UNITS WHERE PROHIBITED BY STATE LAW.

ROBERT M. SWEDROE ARCHITECTS - PLANNERS, AIA, PA. 3014 THE ARCHITECTURAL DESIGN AND DETAIL DRAWINGS FOR THIS BUILDING AND/OR OVERALL PROJECT ARE THE LEGAL PROPERTY OF ROBERT M. SWEDROE ARCHITECTS - PLANNERS, AIA, PA. THEIR USE FOR REPRODUCTION, CONSTRUCTION, OR DISTRIBUTION IS PROHIBITED UNLESS AUTHORIZED IN WRITING BY THE ARCHITECT.

REVISIONS	DATE

C A R L O S Z A P A T A S T U D I O
520 Broadway, Eighth Floor, New York, NY 10012
 T: 212.696.8202 F: 212.696.8242

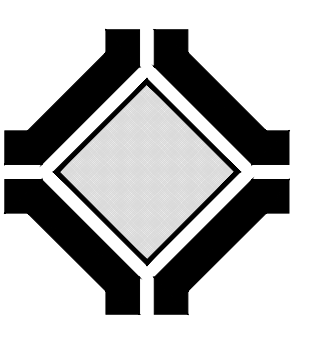

ROBERT M. SWEDROE
 ARCHITECTS PLANNERS
12000 BISCAYNE BOULEVARD, SUITE 602
 MIAMI, FL 33181
 PHONE: (305) 891-2555 FAX: (305) 891-2075

SHEET TITLE
UNIT A-2-MODIFIED
FLOOR PLAN

DRAWN	
CHECKED	
DATE	5-20-2015
SCALE	1/4" = 1'-0"
JOB NO.	1402
SHEET	12
"A-2-MOD."	